

ALOSA

Fixed-type switchboards F.F.F

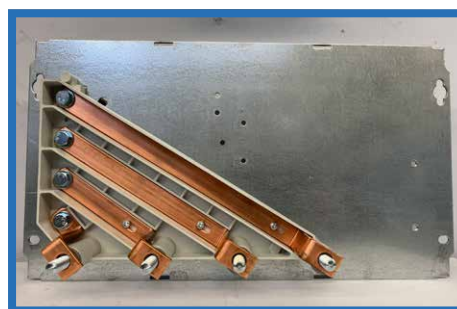
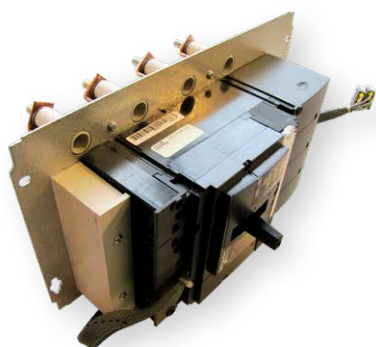

The «ALOSA» switchboards cover the applications where any add on or replacement requires a power switch-off (service index 1.1.1 to 2.2.2, mobility index F.F.F).

NB: The switchboards built with the TABULA structure can mix the ALOSA/BELUGA/SOLEA/ESPADA solutions and cover other service indices, for example IS 2.3.3

Fixed-type switchboards

- Power delivery panels
- Main power distribution panels with fixed functional units
- **Secondary power distribution** panels
- Process **automation** panels

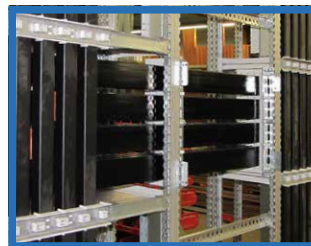
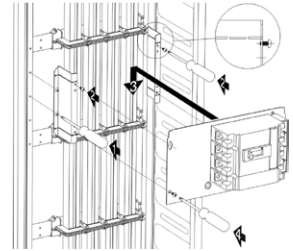
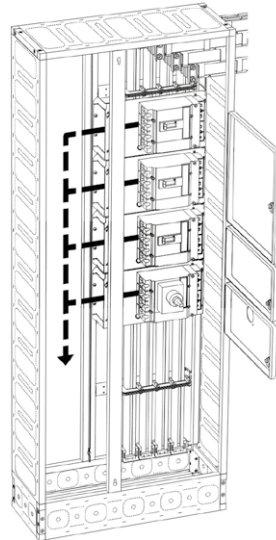

General characteristics

- Fixed-type switchboards
- **IEC/EN 61439-1** and **IEC/EN 61439-2**
- Service index: **IS 1.1.1** to **IS 2.2.2**
- Mobility index: **F.F.F**
- Sectional separation form: **1a** up to **4b**
- Connection front or rear, top or bottom, with cable enclosure of modular width at 126 mm increment (378 mm, 504 mm, etc.)
- Tested and certified
- 3-dimensional modularity
- Standard painting: grey **RAL 7035** or blue **BS 4800**

Bus bars system up to 7 800 A

- Any vertical position (top, middle or bottom)
- Future extension without drilling
- Short circuit current I_{cw} up to 120 kA
- Designed against electric arcs
- Infrared thermography access